

DX-Y62 Y62 FIRE EXTINGUISHER BRACKET

INSTRUCTIONS



DX-Y62 Nissan Patrol Y62 Fire Extinguisher Bracket

Installation Guide

Thank you for purchasing our DX-Y62 Nissan Patrol Y62 Fire Extinguisher Bracket! This bracket is designed to mount a fire extinguisher to your Y62 Patrol's front seat mounts.

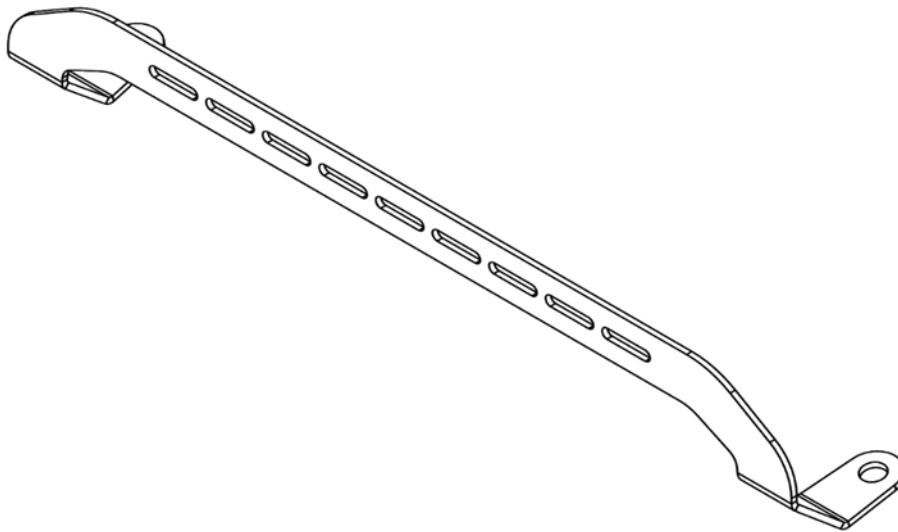

Kit includes:

- x1 DX-Y62 Fire Extinguisher Bracket
- x2 M5 Button Head Screws
- x4 M5 Flat Washer
- x2 M5 Nyloc Nuts

1. Attach your Fire Extinguisher cage (not included) to the Bracket, using the M5 Button Head Screws, Washers, and Nyloc Nuts, then set aside
2. Carefully remove the plastic covers from the front of each seat rail, then remove the seat rail bolts using a 16mm socket
3. Slide assembled bracket underneath the seat rails, ensuring the bracket and rail bolt holes are aligned
4. Reinstall the seat rail bolts, ensuring they are fully tightened, then reinstall plastic seat rail covers

NOTE: Seat bolts should be torqued to 40Nm (30ft/lb) as per manufacturer specs

dashoffroad.com.au